

Radisson Phuket Mai Khao Beach Construction Report

Date: January 2020

Report Number: 003JAN2020



Radisson
PHUKET
MAI KHAO BEACH



Radisson Phuket Mai Khao Beach Construction Progress Report

Disclaimer: <https://turtlebayphuket.com/disclaimer/>

Welcome to the monthly construction report for the Radisson Mai Khao Beach project. This update will be issued monthly during the construction phase and will be available on website at end of each month. It will keep our valued customers up to speed with the progress milestones during the period for construction. We provide a pictorial story and general detail of the works completed within the month, and the works schedule for the following month.

General & Site information:

The site is located in Mai Khao area of Phuket Thailand between Soi Mai Khao 6 And Soi Mai Khao 7

A google map reference can be found on following link:

<https://www.google.com/maps/@8.1238403,98.3072577,1592m/data=!3m1!1e3>

A sales gallery is constructed, and already available on site from 09:00-18:00



Visit onto the construction area is strictly controlled and by appointment only, please contact tom@aplanproperties.com to arrange any visit to the construction area.

The preliminary works commenced in November 2019
Ground works commenced 10th December 2019

Please visit our websites at:

www.turtlebayphuket.com

www.tcphg.com

www.aplanproperties.com

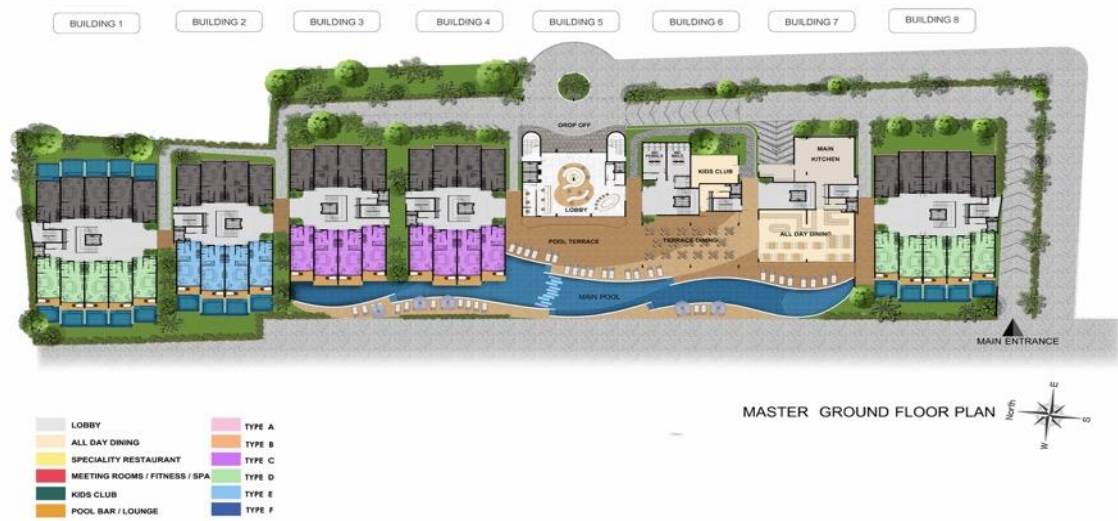

Radisson Phuket Mai Khao Beach Construction Progress Report

Disclaimer: <https://turtlebayphuket.com/disclaimer/>

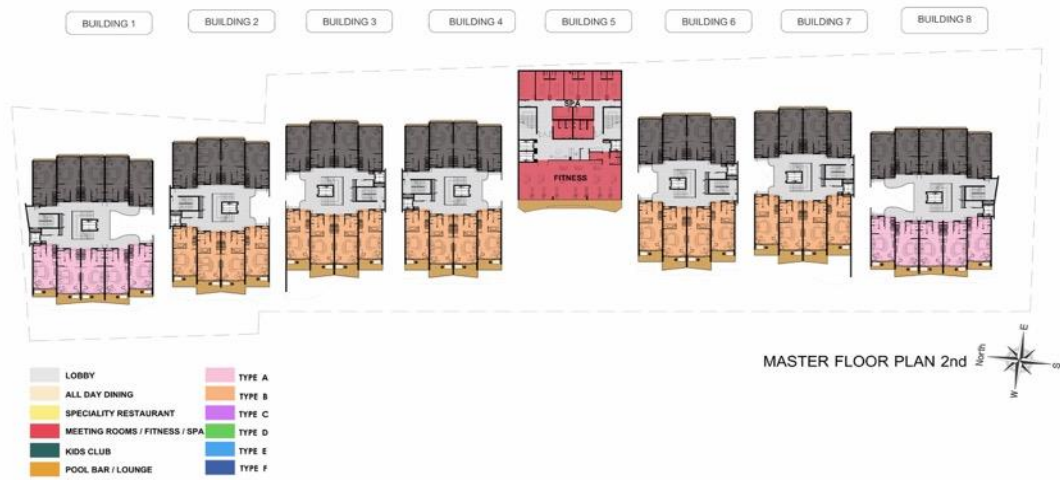

Radisson Phuket Mai Khao Beach Construction Progress Report

Disclaimer: <https://turtlebayphuket.com/disclaimer/>

January 2020

- Piling works- Approximately 700 piles have been completed of total 1200 piles.
- Ongoing footing preparations, such as liens, waterproofing and pouring of the footings
- Mock-Up unit completion & Inspection

February 2020 Forecast

Ongoing Piling works, approximately 15 to 20 piles per day are expected on average are driven to a depth of 24 Metres. The total piles to be driven are 1,200 sets, Phase 1 piling for the site is for the whole area, excluding the area on which the sales gallery currently sits. Phase 2 piling will be in the area taken up currently by the sales gallery area, this phase 2 piling will be done when sales gallery is relocated at future date. Phase 1 piling (approx. 950 Sets) is due for completion within February.

Ongoing sample test of the dynamic load testing of the piling works as per the advice of the structural engineers

Cutting of the exposed remainder of the pile to the footing level

Ongoing pouring of liens for the footings

Waterproofing footings

Preparation of Basement slabs zone by zone as other foundation tasks complete by zone

Ongoing technical services meetings with Radisson hotel tech service team, and the project owners and consultants- approximately every 6 to 8 weeks the on ground teams meet with the Hotel operator teams for update design, discussion with engineers, discussion with architects and consultants in conjunction with meeting the specified needs and standards of the brand. This will continue during the total construction phase, and at milestones within the project, in addition as time progresses towards completion, then other key areas of the hotel operations will begin to become involved.

Photos



Piling works at Building 7 & 8 Area





Piling in Building 7& 8 footprint



Piling work at 7& 8, looking back across 5,6 (pile heads are already cut off in 5&6 area)



Preparing Liens at top of piles in Building 4 after the lien concrete base the footings will be attached to these pile heads by rebar & structural concrete pour





Footings being prepared ready for structural concrete in Building 2 – these are in the area of the water tanks





Directly in front of the plot, road and cycle/pathway and to the right onto the beach



Radisson Phuket Mai Khao Beach Construction Progress Report

Disclaimer: <https://turtlebayphuket.com/disclaimer/>



Start of the beach areas opposite the edge of the plot (at building 8 end)



View of the beach, looking to the south



Beach looking to the north



From the beach looking East, back to the project

Radisson Phuket Mai Khao Beach Construction Progress Report

Disclaimer: <https://turtlebayphuket.com/disclaimer/>